

4500 kg

Manual

400 V

4-Post-lift

Item No.: TW 445

Description

Electro-hydraulic four-post lift.
With rear sliding plates and front recesses for optional turntables. This lift is ideal for wheel alignment and all other service work.
Jacking beam also optionally available.

Features

- 1A Quality built with CE-Certificate
- Manufactured in accordance to ISO 9001
- Lift capacity 4500 kg
- CE-Certificate
- IP 54 24V control box
- 24 V limit switch
- Hydraulic overflow valve
- Roll off protection
- Safety lock for entire lifting height
- Cable break safety device
- Sliding plates
- Foot protection
- Acoustic warning signal

Delivery contents

- Lift incl. Power unit
- Heavy duty anchor bolts (16 pcs.)
- Examination book and CE-Certificate
- Optional: Turntables
- Optional: Jacking beam (2 t / Pneumatic)
- [Product video online](#) | [Assembly video](#)

optionally available:

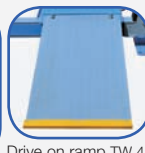
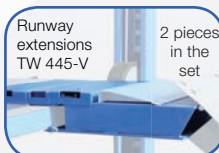
 Drive on ramp TW 445R
2 pieces in the set



Product video



Assembly video

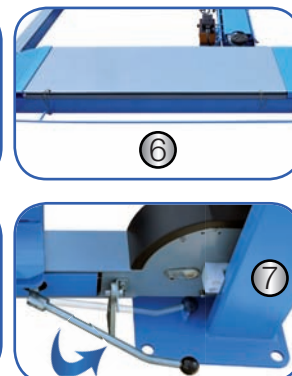
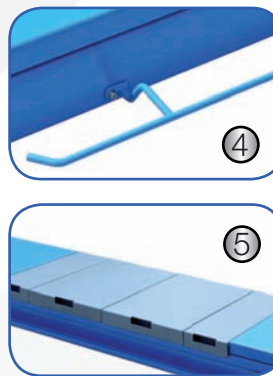
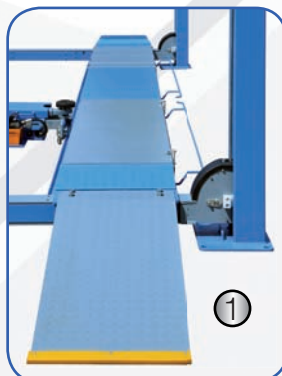

Details



- (1) Wide drive on ramps / Long platforms, ideal for transporters and long wheelbase vehicles (2) Easy to use control box (3) Powerful electric motor
(4) Foot Protector (5) Removable plates for optional turntable (6) Sliding plates (rear) included (7) Manual release

Dimensions and technical data

Minimal wheel base for the alignment: 1600 mm

Maximum wheel base for the alignment: 3700 mm | Maximum wheel base for the lift: 4320 mm

Total length of the lift (including ramps): 5867 mm

Foundation requirement: (L) 5140 mm x (W) 3400 mm x (concrete strength C20/25) 150 mm

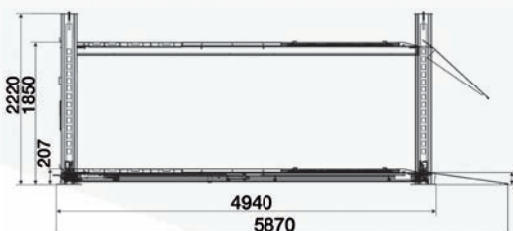
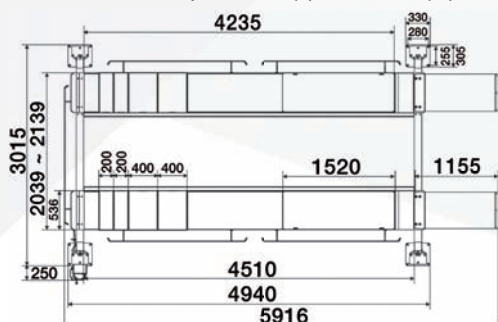

Technical Data: TW 445

Lifting capacity	4500 kg
Lifting height max.	1850 mm
Runway length	4510 mm
Runway width	536 mm
Drive on height	126 mm
Lifting time (approx.)	50 sec.
Power supply	400 V / 3 Phase
Motor power	2,2 kW
Fusing	16 A / type C
Weight (approx.)	1400 kg