

Wheel balancer

hand operated | Item No.: TW F-100

Description

The TW F-100 is a perfect basic model that complements our tyre mounting machine TW X-610 with a wheel balancer (hand operated) in a top price-performance ratio. It is perfect for limited space. Handbrake for fixing the shaft during wheel mounting, balancing and braking. Power supply: 220 V and 12 V connection. High ease of use and innovative, space-saving design. *Only suitable for our tyre changer TW X-610.*

Features

- 1A Quality built with CE-Certificate
- Manufactured in accordance to ISO 9001
- Automatic balancing, manual wheel braking
- Handbrake for fixing the shaft during wheel mounting, balancing and braking
- Easy handling | Solid construction
- Digital display | Static and dynamic balancing
- various programs selectable: Normal / Static / Alu1, Alu2, Alu3, Alu-S / Motorcycle etc.
- Integrated calibration and self-diagnostic program
- **Optional:** Motorcycle adapter, diverse vehicle adapter

Delivery contents

- Wheel balancer TW F-100
- Centering cones (4 pcs.) gauge, weight pliers
- Quick release nut, Pressure cup, Rubber lip
- Calibration weight | English instruction manual
- CE-Certificate
- **Product video online**
- **Assembly video**



Product
video



Assembly
video



TW F-100 + TW X-610
also available as a set!

Please consult our technical decision-maker (on page 51)
before purchasing your wheel balancer (s)!

Details

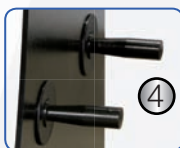
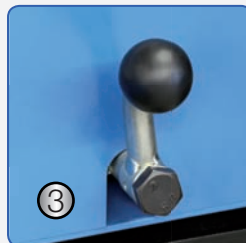
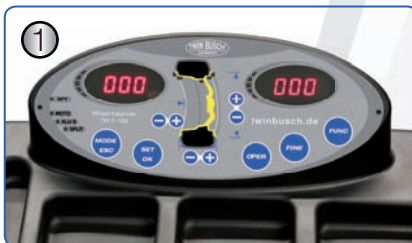

- (1) Digital display (2) Shaft diameter 36 mm (3) Handbrake for fixing the shaft during wheel mounting, balancing and braking
(4) Attachment possibility for centering cones and gauge (5) Storage compartments for cones (6) Quick release nut $\varnothing = 36$ mm
(7) Perfect accessory to the tyre changer TW X-610

Dimensions | Technical Data | Accessories

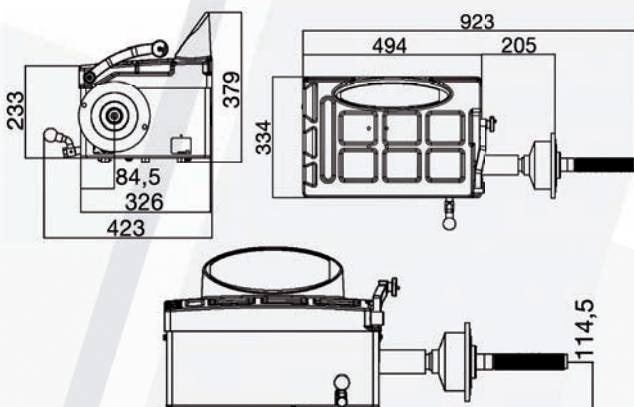

Extensive accessories

Technical Data: TW F-100	
Wheel width	1,5" - 20"
Wheel diameter	10" - 24"
Wheel weight (max.)	65 kg
Measuring time (approx.)	8 sec.
Power supply	12 V and 230 V
Noise level	< 70 dB
Weight (approx.)	69 kg



Only suitable for
our tyre changer
TW X-610!